

mFieldwork Mobile Application Documentation

Installing the mobile application

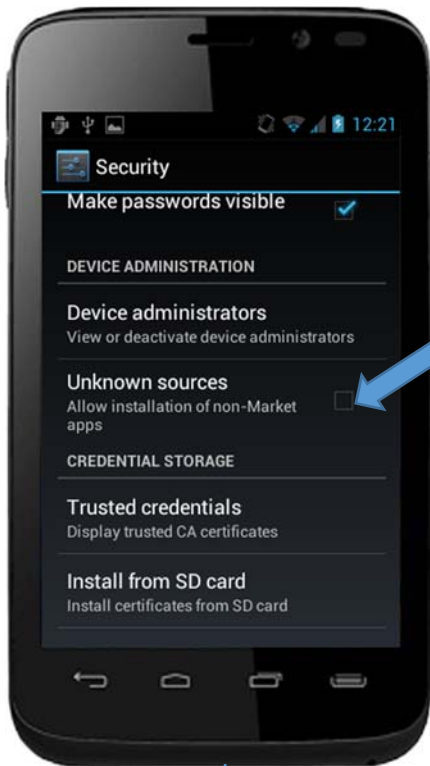



8. Click to tick the check box 'Unknown sources'



9. The check box 'Unknown sources' is now ticked



10. When the attention Prompt appears click OK



11. Click on Install



12. Wait for the process to finish installing



13. Click on the done to accept the installation or Open to accept and open the application

Uninstalling the mobile application



1. Click on settings

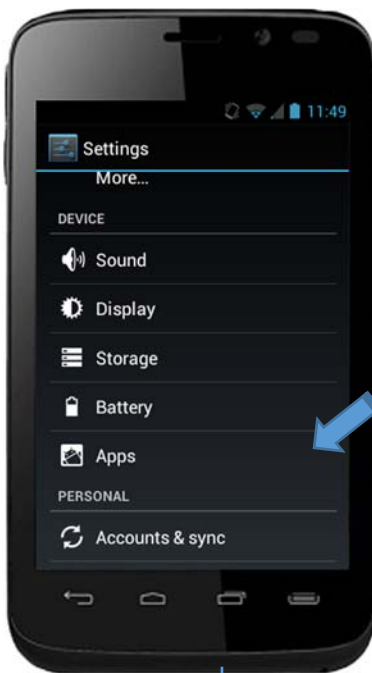

2. Click on Apps

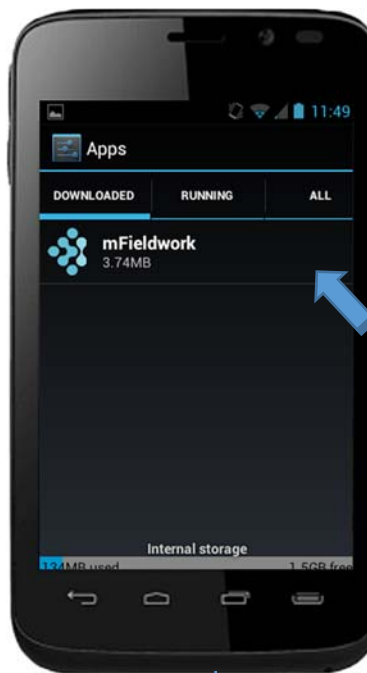

3. Click on downloaded tab and click the mFieldwork icon

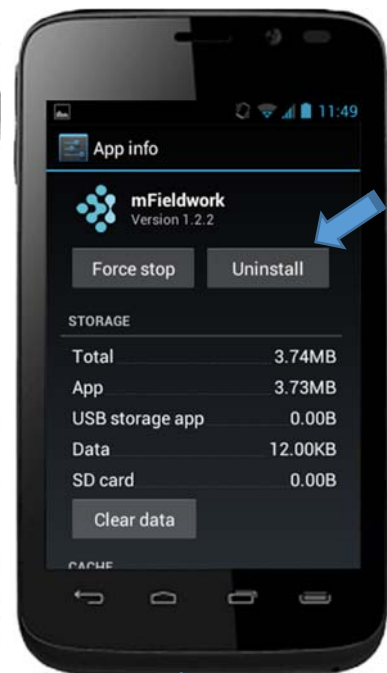

4. Click on Uninstall

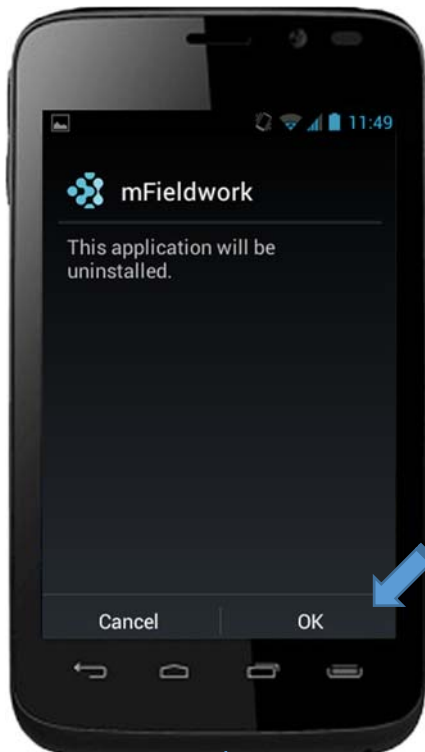

5. When prompted with this message click on OK



1. Wait for the uninstallation process to finish

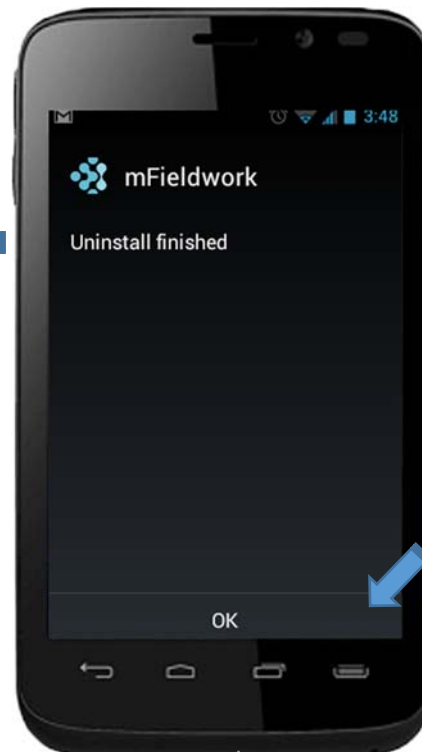

7. Once prompted 'Uninstall finished' click on OK

Open the mFieldwork application



Connect to Wi-Fi



1. Click on Settings



2. Swap the Wi-Fi button to the right (OFF to ON).

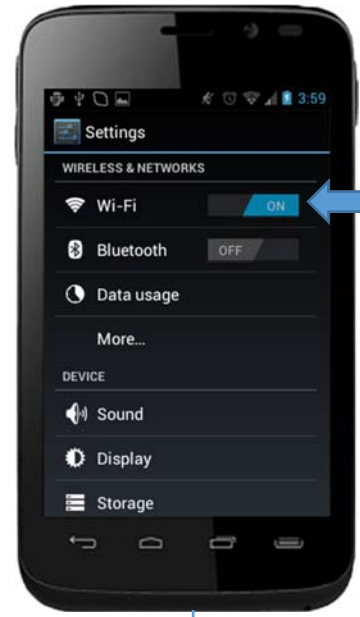

3. The Wi - Fi is now ON



4. Click on your preferred wireless network



5. If it is password protected, enter the wireless password and click on save

Turn off Wi-Fi when in the field



3. Click on settings



4. Swap the Wi – Fi button to the left i.e. ON to OFF



Turning on the GSM data connection



1. Click on Data Usage



2. Swipe the mobile data button: OFF to ON



3. The Mobile data usage is now ON

Turning OFF GSM

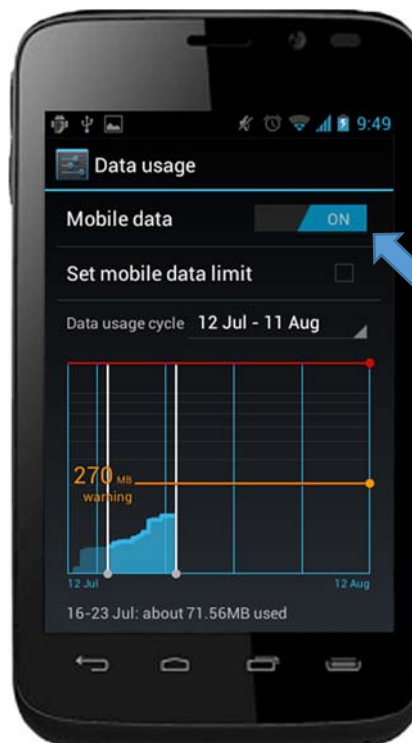

1. Swipe the mobile data button: ON to OFF

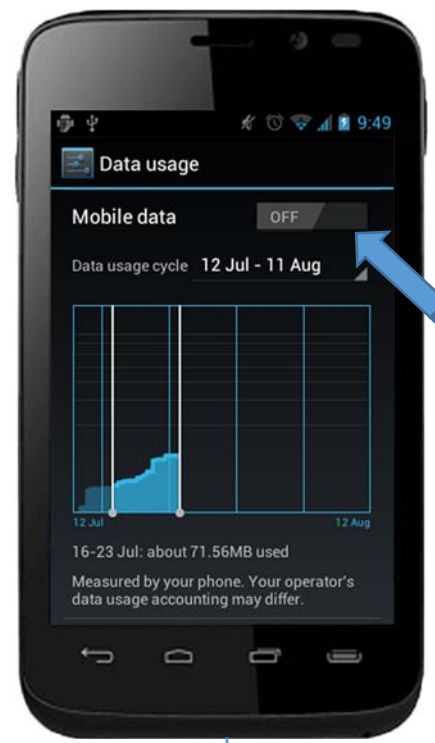

2. The Mobile Data Usage is now OFF

Activate GPS



1. Click on Settings

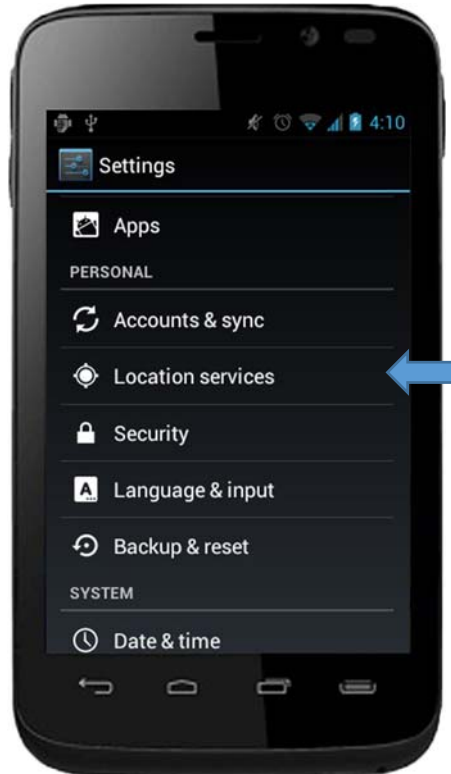

2. Click on Location Services

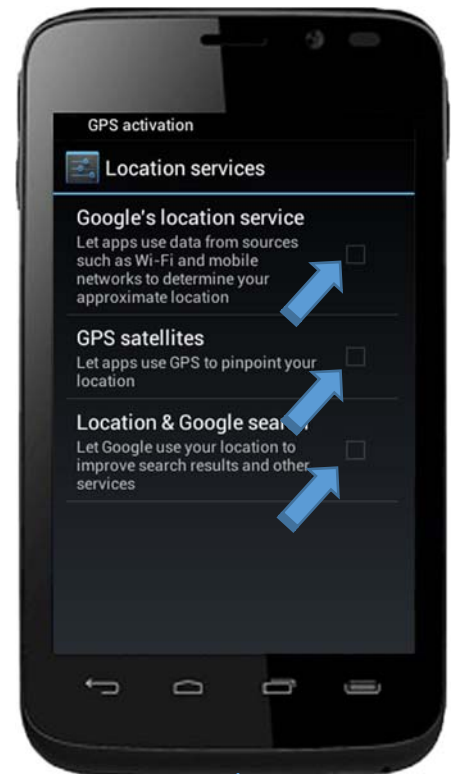

3. Click to tick on GPS satellites, Google's location Service and Location & Google Search

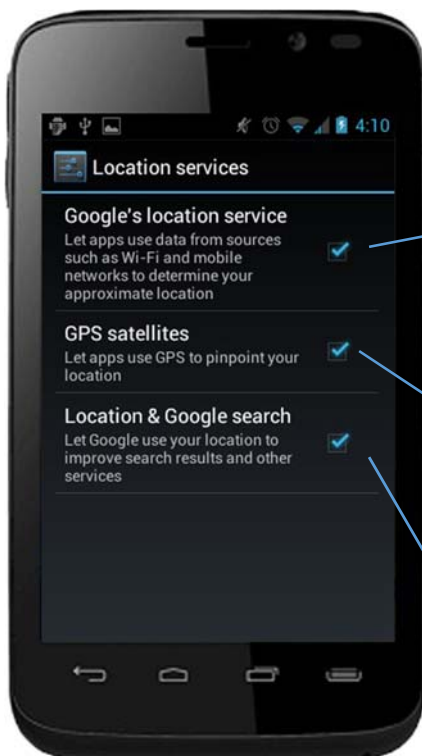

Check this to allow the application to find its location using the cellular and Wi-Fi networks. **RECOMMENDED.** If prompted with the following message on the right click on agree, if not prompted restart the phone and when it prompts this message click on agree.

Check this to allow the application to find its location using the GPS satellite system. **RECOMMENDED**

Use My Location

Do you want to allow Google to use location for improved search results and other services?

Disagree

Agree

Click on Agree when prompted with this message

Location consent

Allow Google's location service to collect anonymous location data. Some data may be stored on your device. Collection may occur even when no apps are running.

Disagree

Agree

Turning OFF the GPS



1. Click on settings

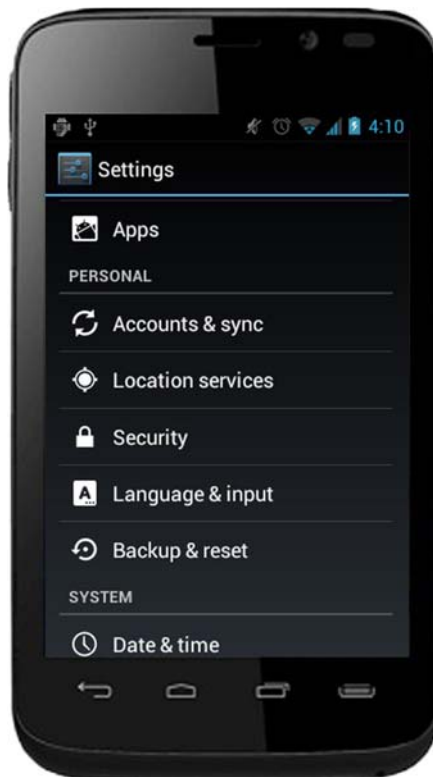

2. Click on Location services

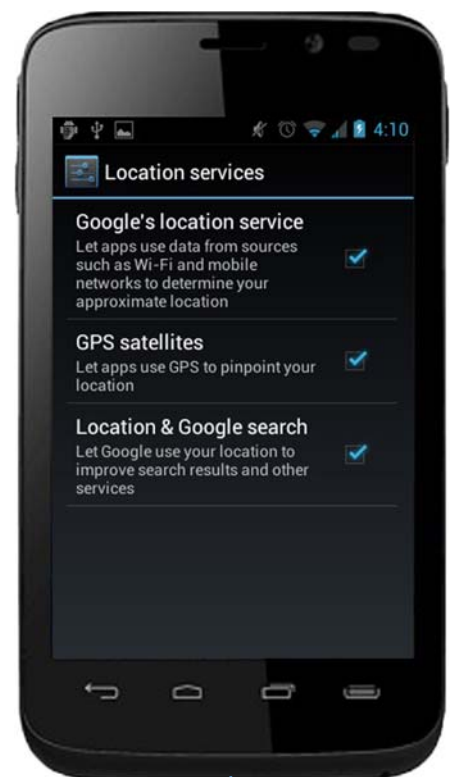

3. Uncheck the check boxes

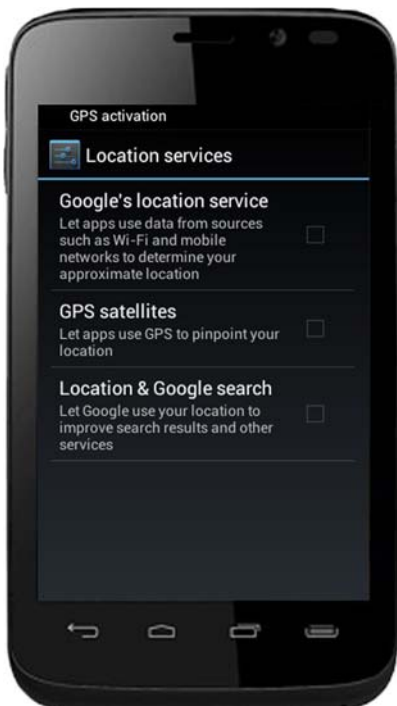

4. The GPS is now OFF

Log in



5. Click on Login button and make sure you are online



2. Enter your correct username and password



3. Wait for the application to finish downloading surveys assigned to you



4. The Log in button changes to Log out to show that you are currently logged in.

Downloading Surveys



1. Click on Download and make sure you are online



2. Wait for the surveys to download

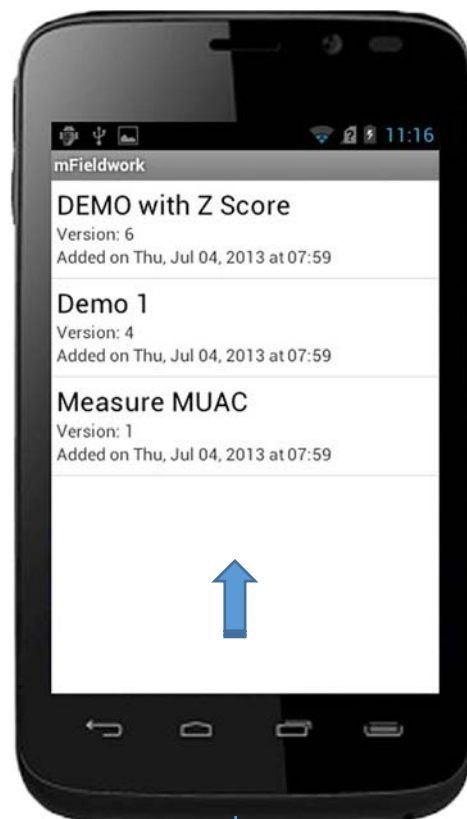

3. Click on list of surveys to view the updated list of surveys.



4. When there's no survey to download this message appears: 'Sorry, there are no available surveys for download'

Uploading Records



1. Click on Upload button and make sure you are online



2. Wait for the records to be send



3. Press OK after completion is Successful

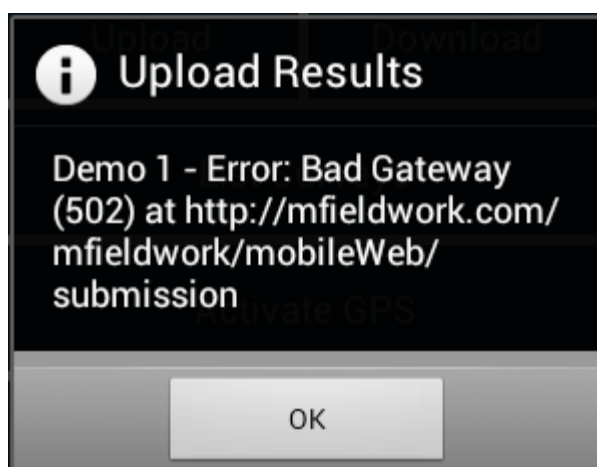

4. In-case of this error during upload click on OK, then check your network connection and make sure you are online then click on upload once more.

Open, Collect and Save a record.



1. Click on the list of Surveys

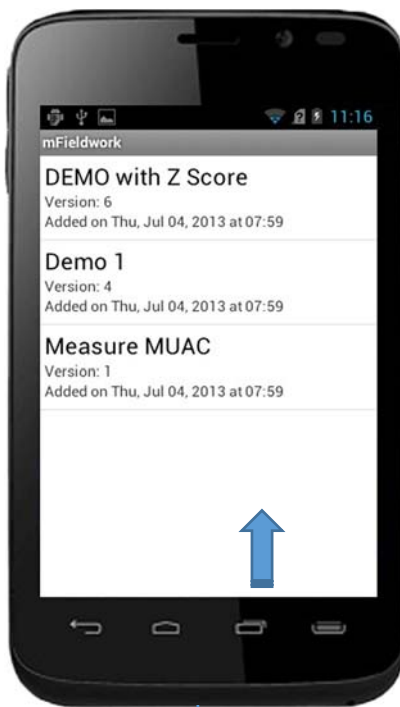

2. Select the survey you want from the list

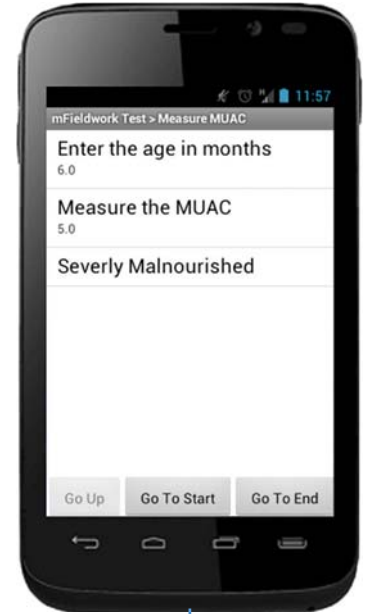

Occurs if a record is left unsaved. **Go to start** means to go to first question, **Go to end** means going to the end of the record and **Go up** means going to the top of the list of questions already answered in the list.

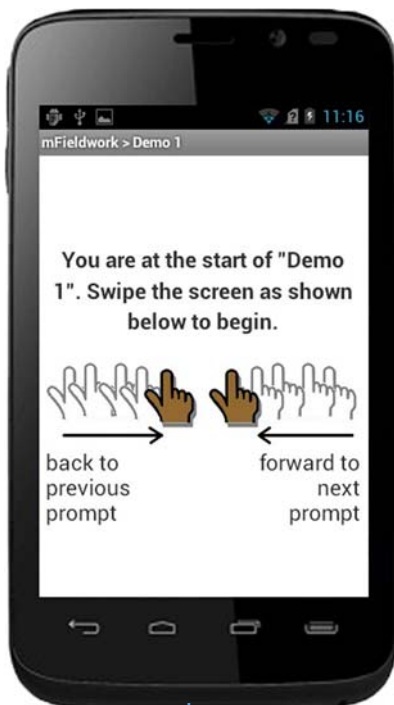

3. Swipe the screen as instructed in the survey welcome screen



4. Undertake the survey and swipe to view the next question.



5. You can edit anything before you click on save record and exit button

Help Menu



1. Click on Menu option button on the phone when the mFieldwork application is open



2. Click on Help

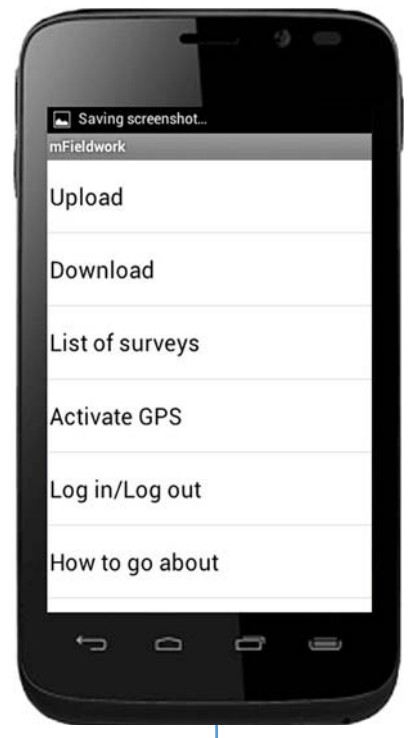

3. Select the option you want help from the list.



4. Scroll and read the help then finally click on OK to exit the screen back to the help list.