

WATLE AND DAUB ONE STOREY BUILDING

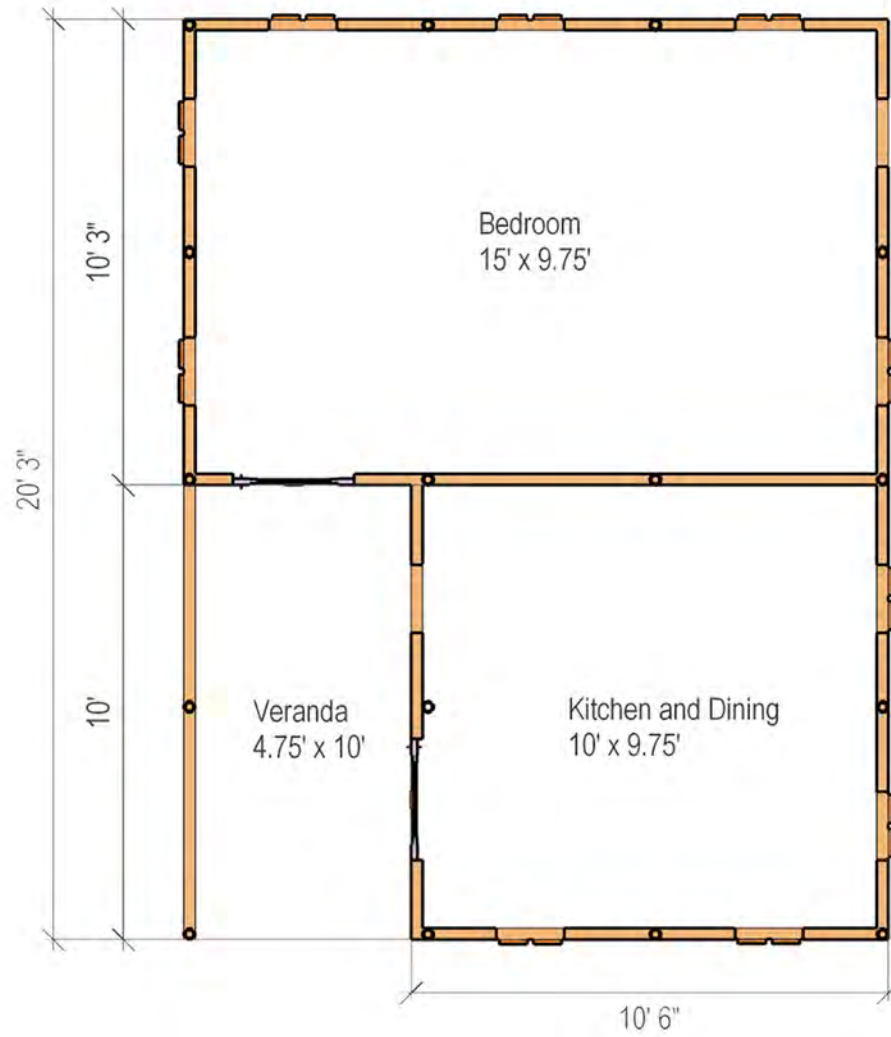

FLOOR PLAN



VIEW

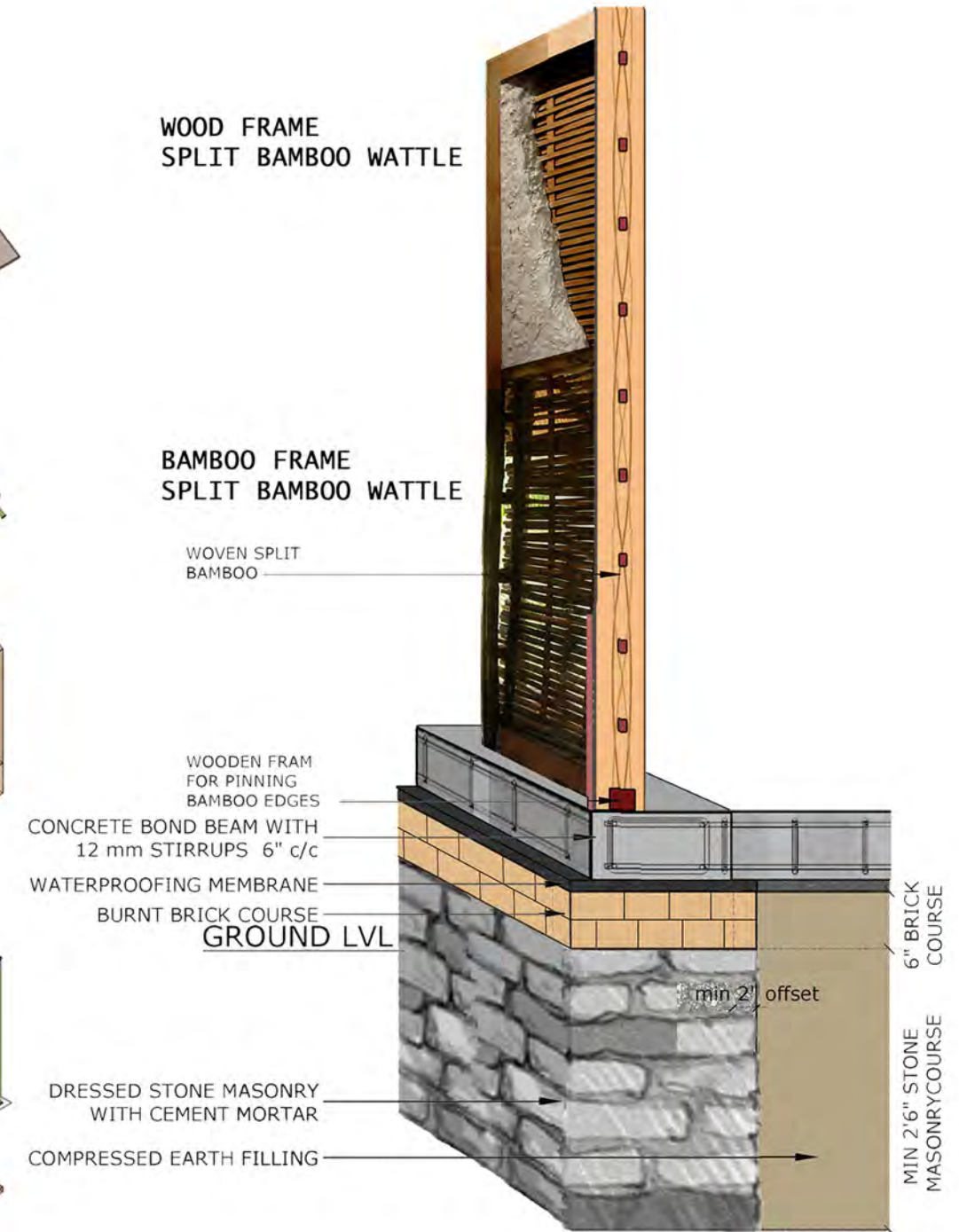
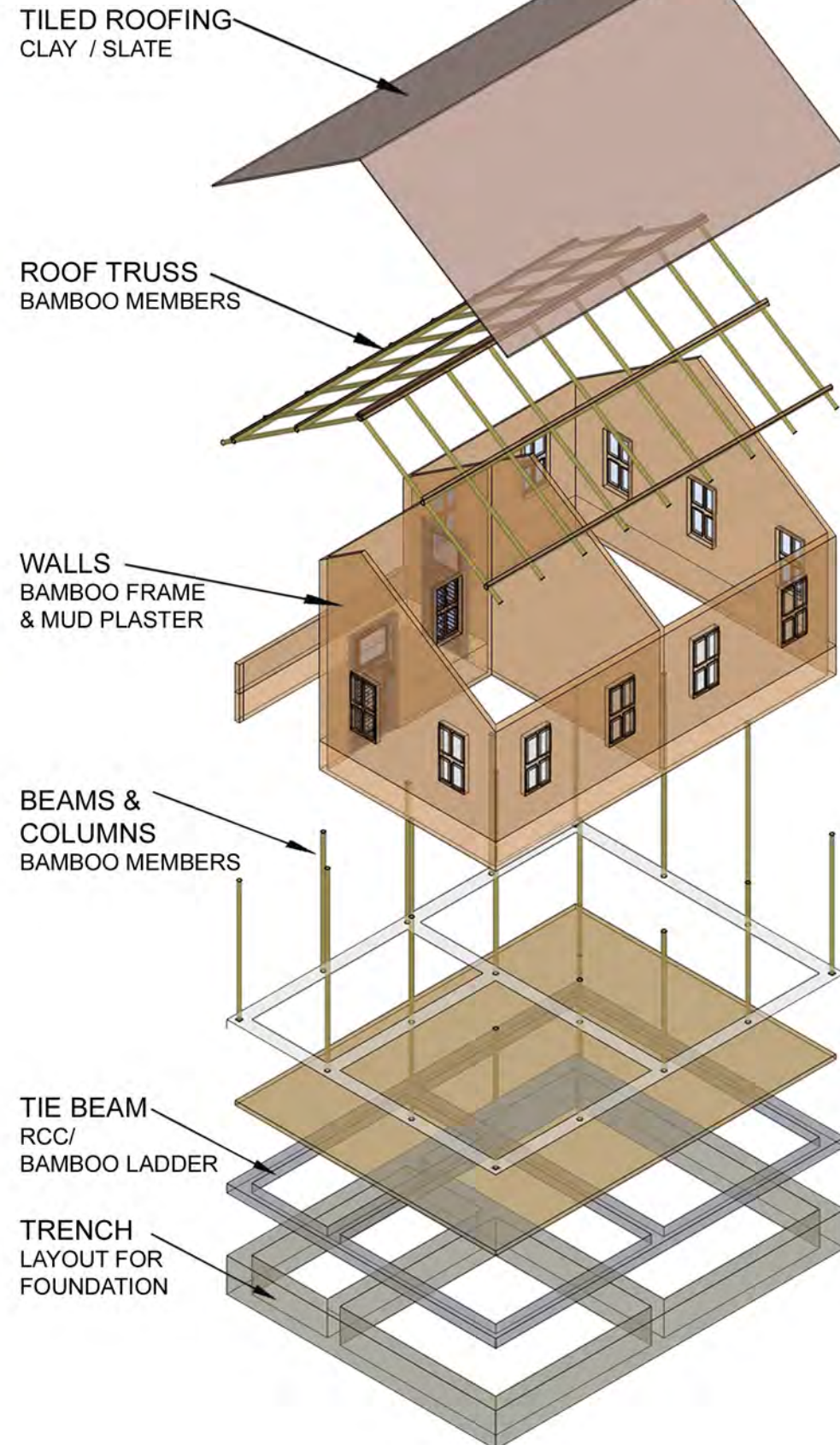

WALL SECTION

SPECIFICATIONS

| | |
|-------------------|-------------------------------|
| FLOOR AREA | 265 SQFT |
| MATERIALS | |
| FOUNDATION | STONE MASONRY + RCC BEAM |
| WALLS | WATTLE AND DAUB |
| BEAMS | BAMBOO |
| FLOORS | MUD FLOOR(G) |
| REINFORCEMENTS | BAMBOO |
| ROOF | BAMBOO WITH WOOD PURLINS |
| COST | ESTIMATED 3,50,000 NRS |

WATTLE AND DAUB TWO STOREY BUILDING

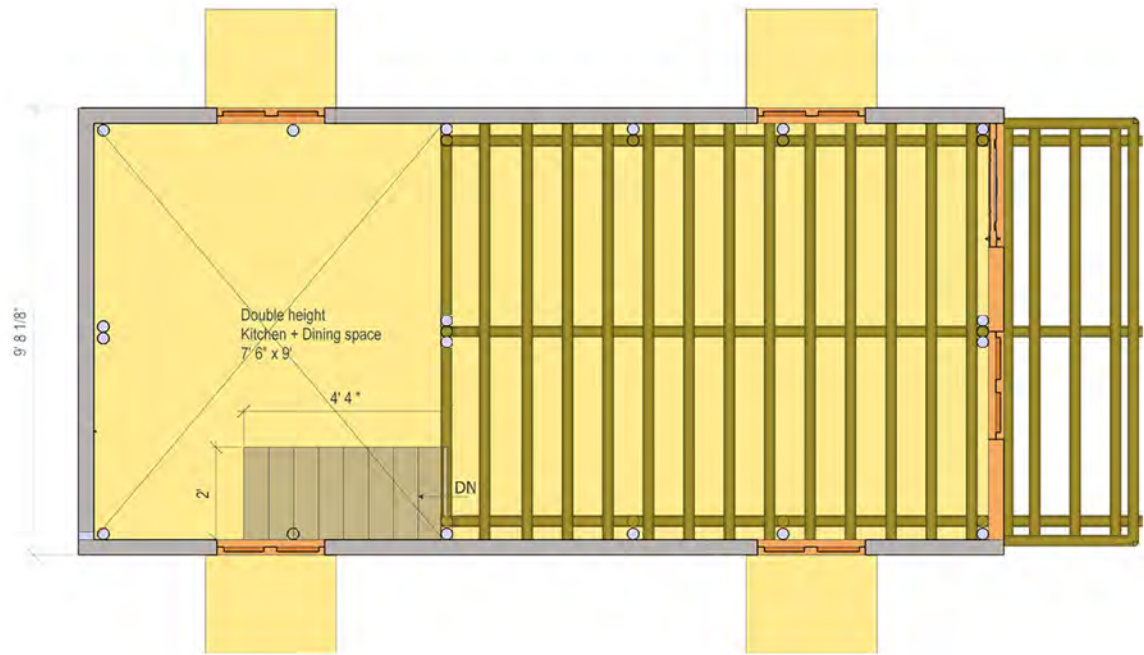
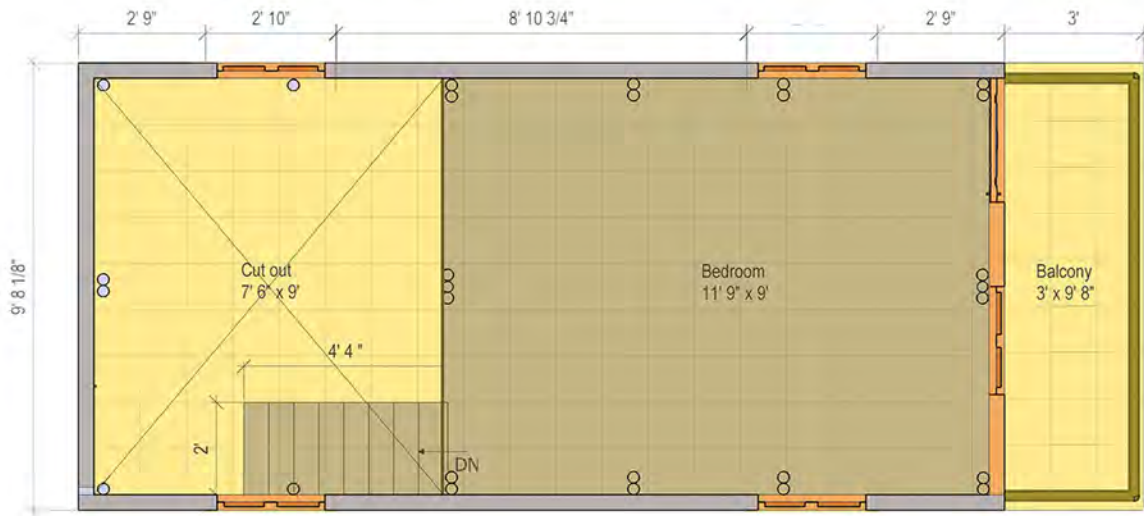

FLOOR PLANS



VIEW

TILED ROOFING
CLAY / SLATE

ROOF TRUSS
BAMBOO MEMBERS

BALCONY
BAMBOO MEMBERS

WALLS
BAMBOO FRAME
& MUD PLASTER

BEAMS &
COLUMNS
BAMBOO MEMBERS

TIE BEAM
RCC/BAMBOO LADDER

FLOOR
MUD FINISH FLOORING

FOUNDATION
STONE MASONRY
WITH VERTICAL
REINFORCEMENT

TRENCH
LAYOUT FOR
FOUNDATION

WOOD FRAME
SPLIT BAMBOO WATTLE

BAMBOO FRAME
SPLIT BAMBOO WATTLE

WOVEN SPLIT
BAMBOO

WOODEN FRAM
FOR PINNING
BAMBOO EDGES
CONCRETE BOND BEAM WITH
12 mm STIRRUPS 6" c/c
WATERPROOFING MEMBRANE
BURNT BRICK COURSE
GROUND LVL

DRESSED STONE MASONRY
WITH CEMENT MORTAR
COMPRESSED EARTH FILLING



WALL SECTION

SPECIFICATIONS

| | |
|-------------------|-------------------------------|
| FLOOR AREA | 310 SQFT |
| MATERIALS | |
| FOUNDATION | STONE MASONRY + RCC BEAM |
| WALLS | WATTLE AND DAUB |
| BEAMS | BAMBOO |
| FLOORS | MUD FLOOR(G) WOOD(FF) |
| REINFORCEMENTS | BAMBOO |
| ROOF | BAMBOO WITH WOOD PURLINS |
| COST | ESTIMATED 6,50,000 NRS |

ADOBE AND STONE MASONRY ONE STOREY BUILDING

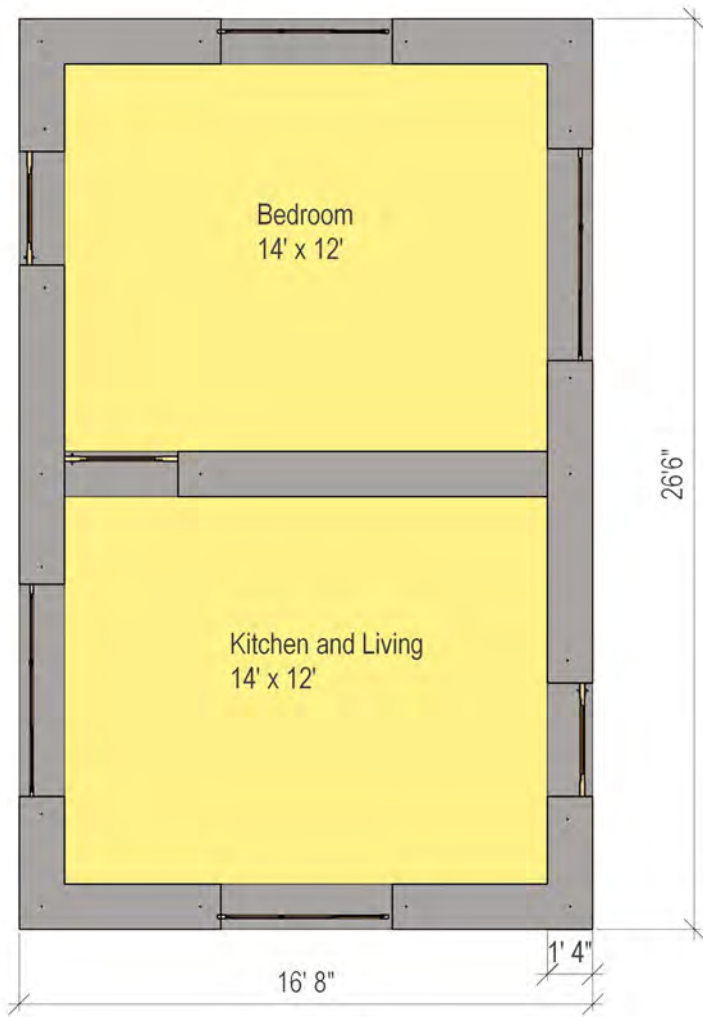

FLOOR PLAN

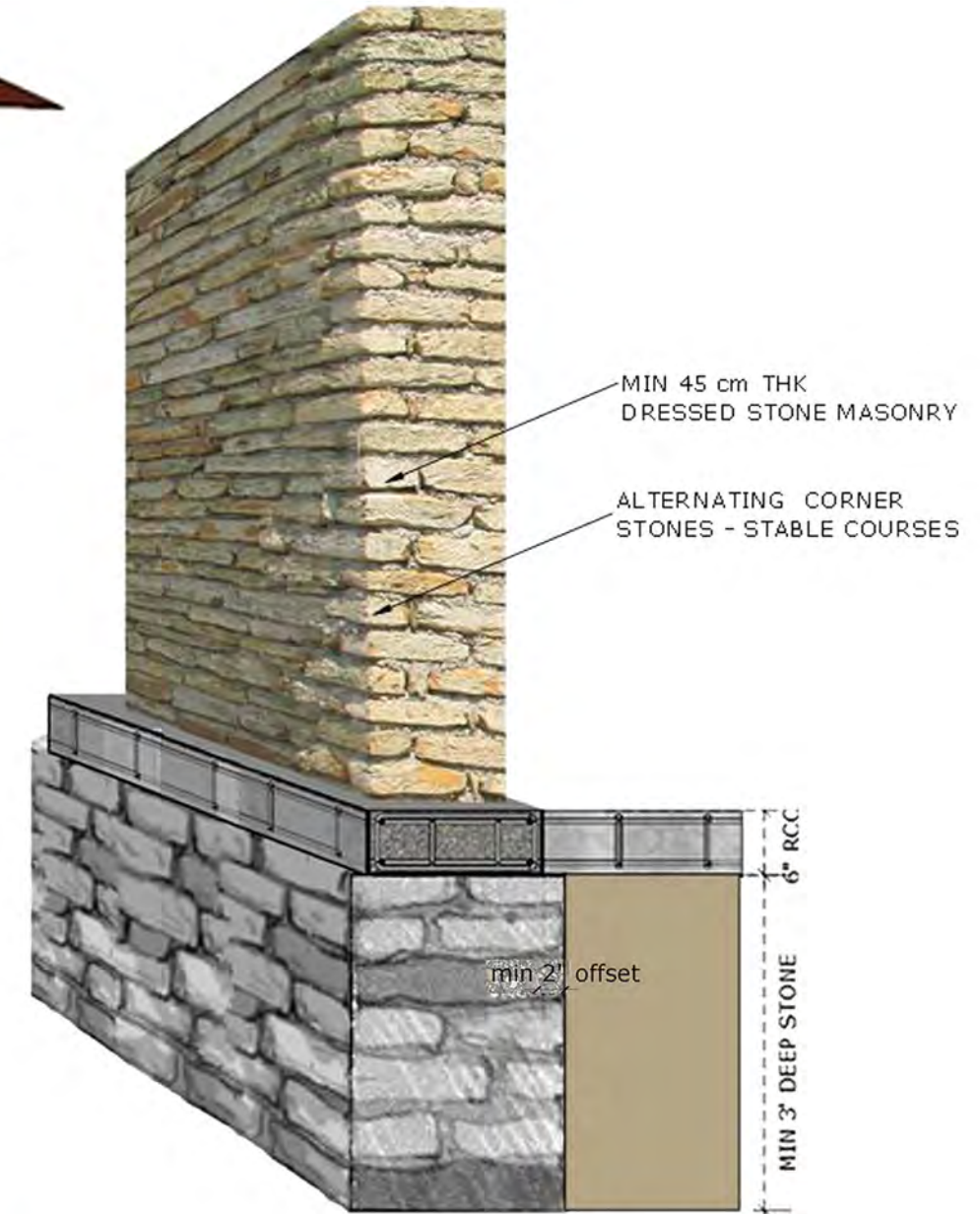
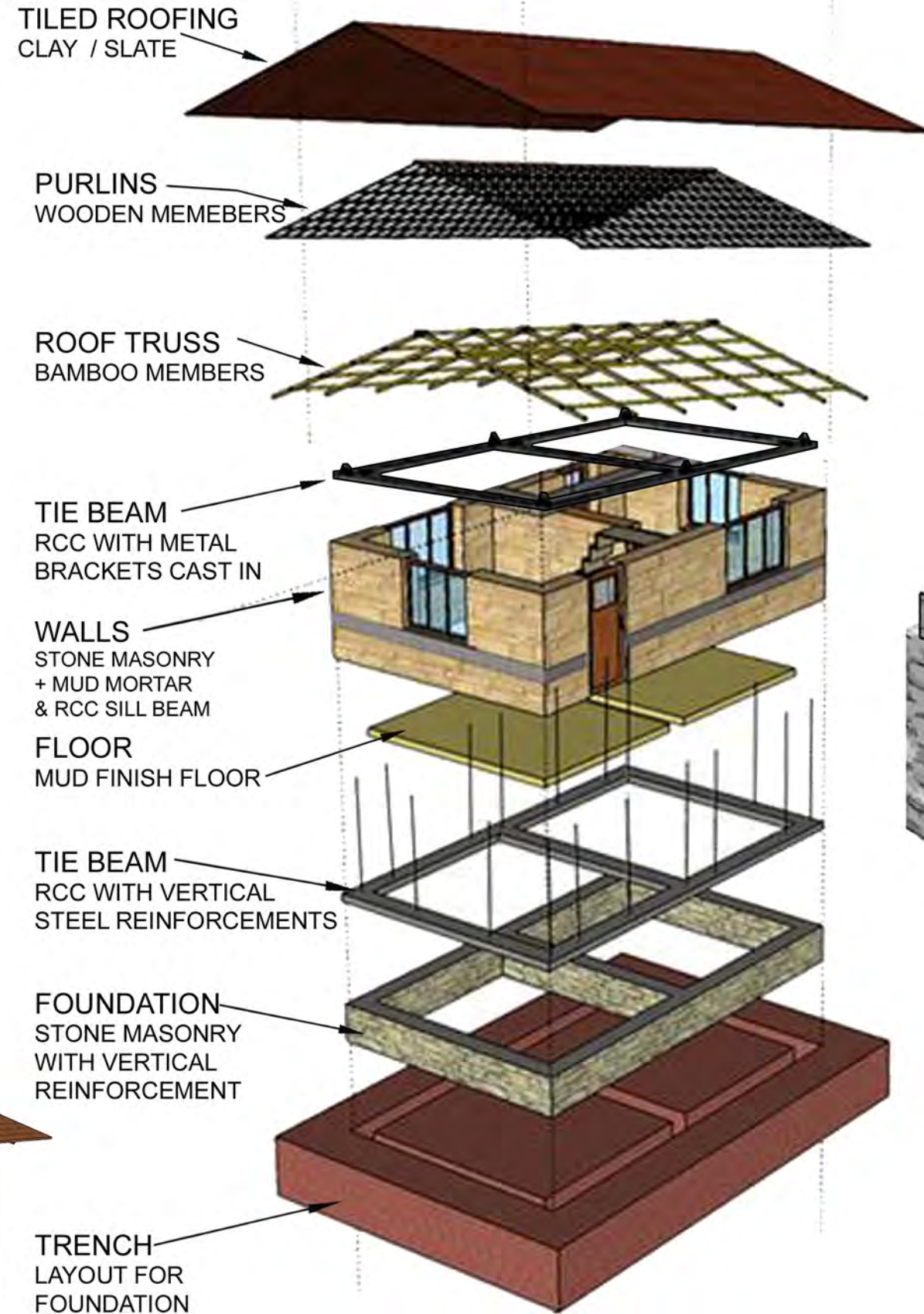

WALL SECTION



VIEW

SPECIFICATIONS

| | |
|-------------------|-------------------------------|
| FLOOR AREA | 310 SQFT |
| MATERIALS | |
| FOUNDATION | STONE MASONRY + RCC BEAM |
| WALLS | STONE / ADOBE |
| BEAMS | RCC TIE BEAM |
| FLOORS | MUD FLOOR(G) WOOD (FF) |
| REINFORCEMENTS | STEEL BARS |
| ROOF | BAMBOO WITH WOOD PURLINS |
| COST | ESTIMATED 3,50,000 NRS |

ADOBE AND STONE MASONRY TWO STOREY BUILDING



FLOOR PLANS

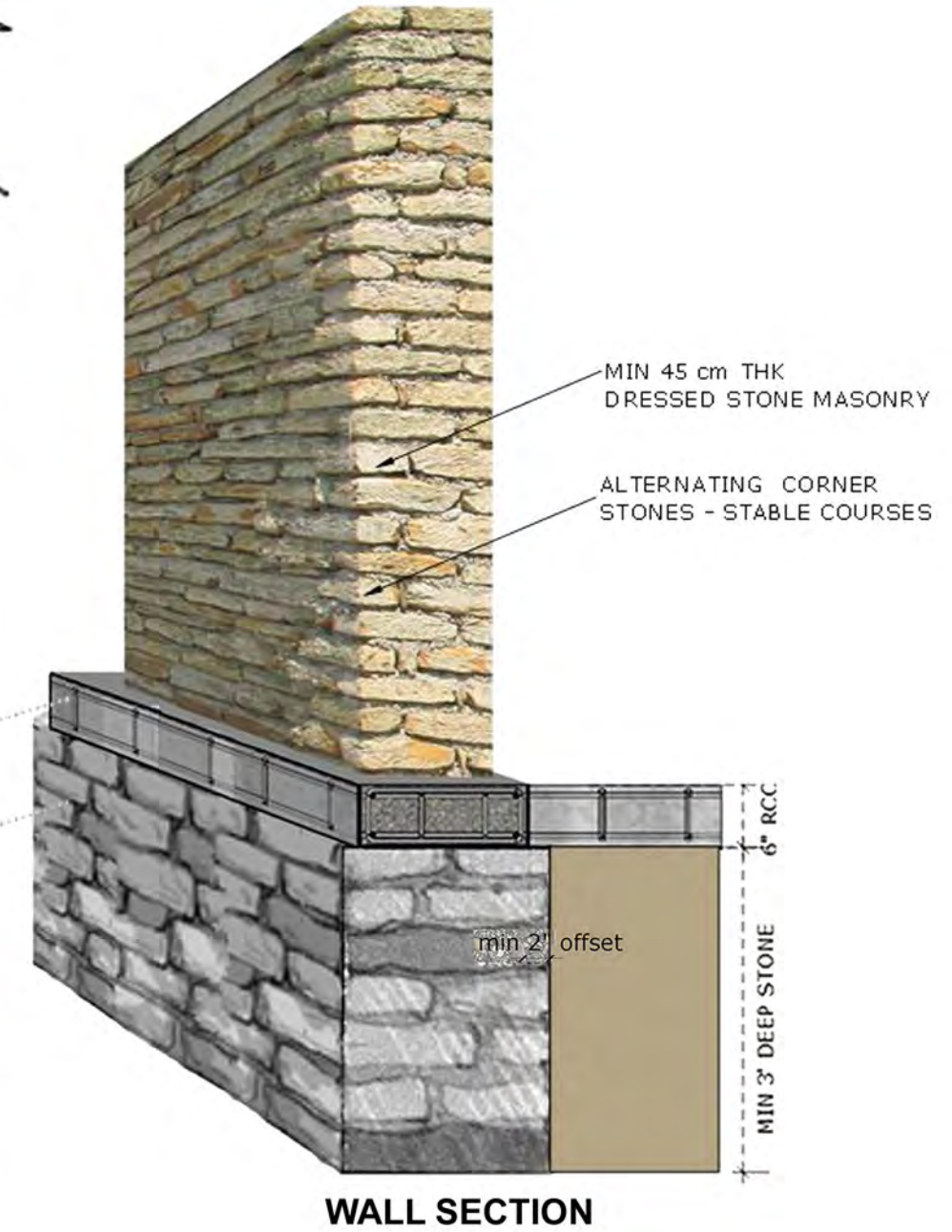
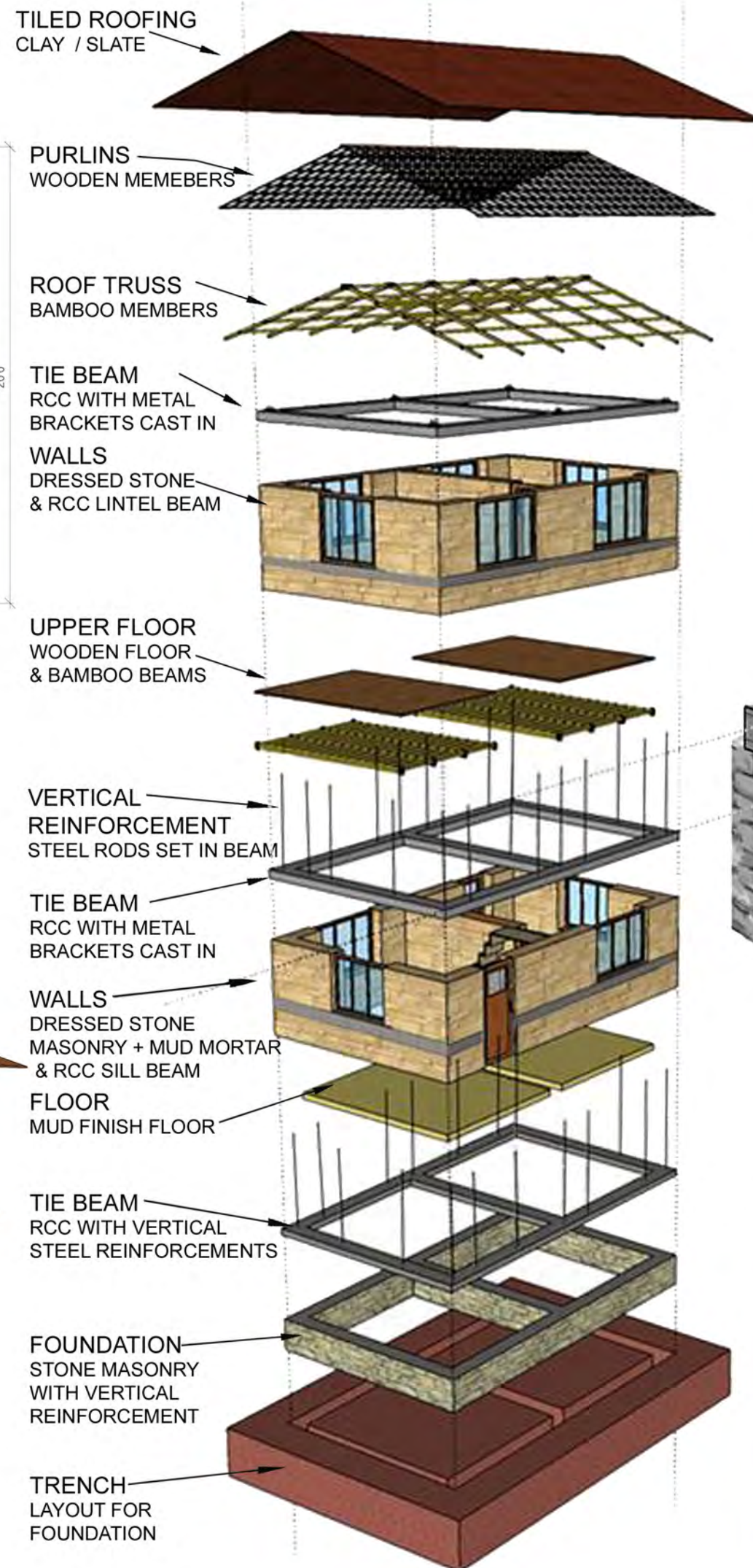

SPECIFICATIONS

| | |
|-------------------|-------------------------------|
| FLOOR AREA | 610 SQFT |
| MATERIALS | |
| FOUNDATION | STONE MASONRY + RCC BEAM |
| WALLS | STONE / ADOBE |
| BEAMS | RCC TIE BEAM |
| FLOORS | MUD FLOOR(G) WOOD (FF) |
| REINFORCEMENTS | STEEL BARS |
| ROOF | BAMBOO WITH WOOD PURLINS |
| COST | ESTIMATED 6,50,000 NRS |

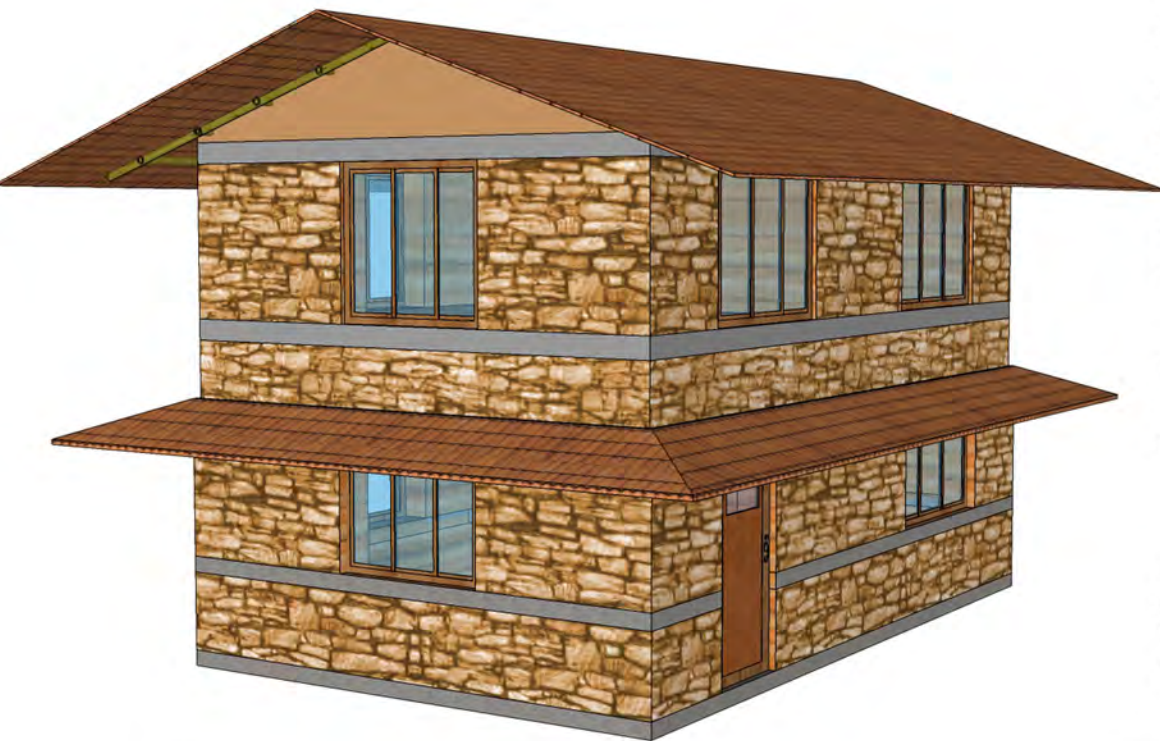

VIEW

RAMMED EARTH ONE STOREY BUILDING

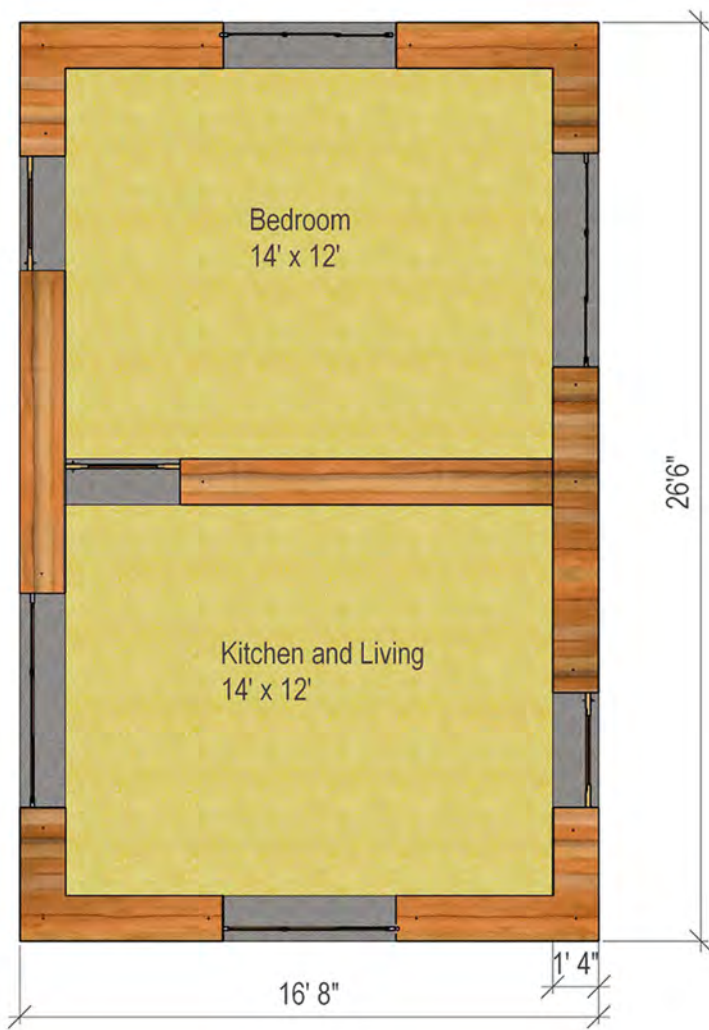

FLOOR PLAN

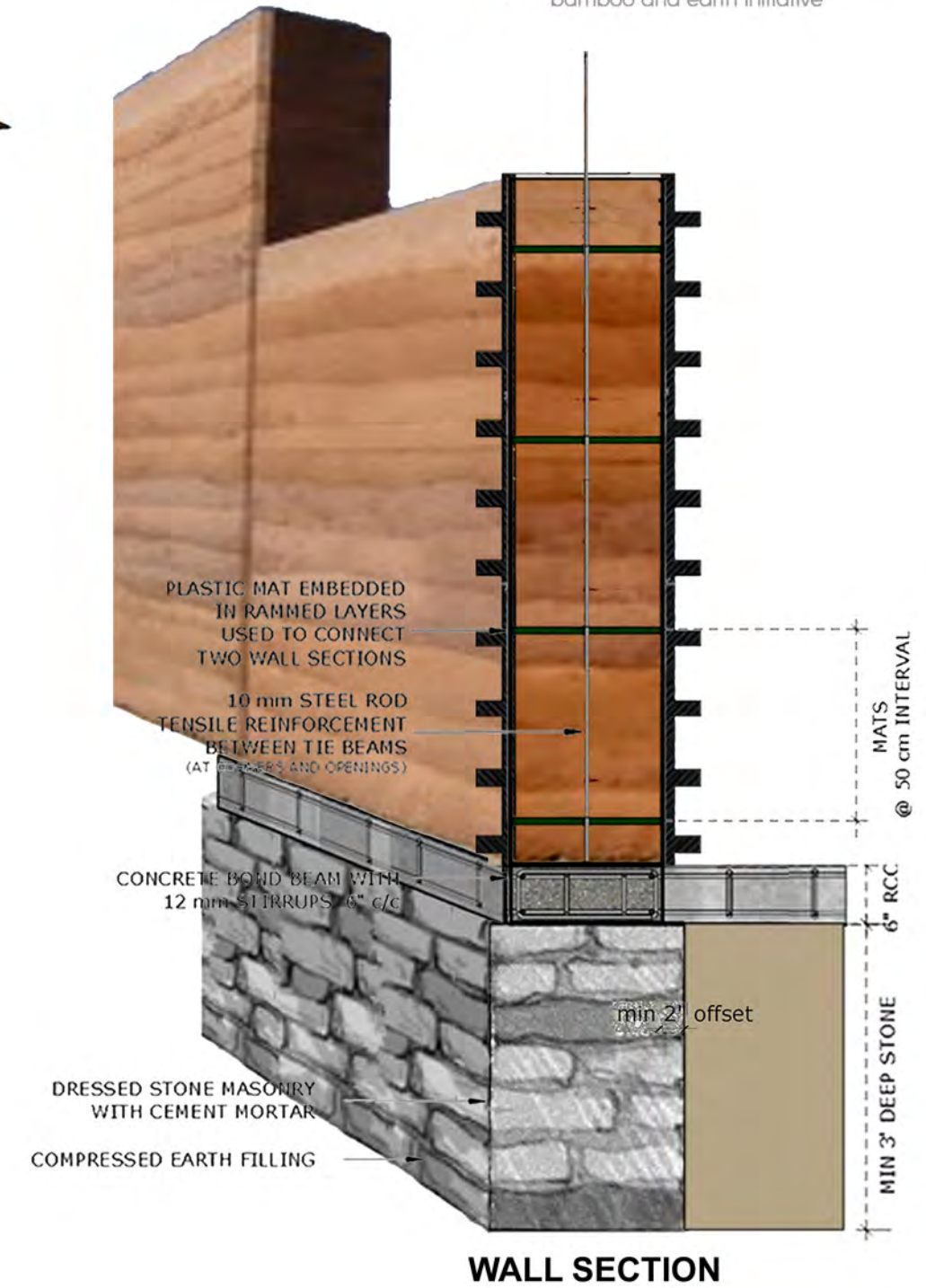
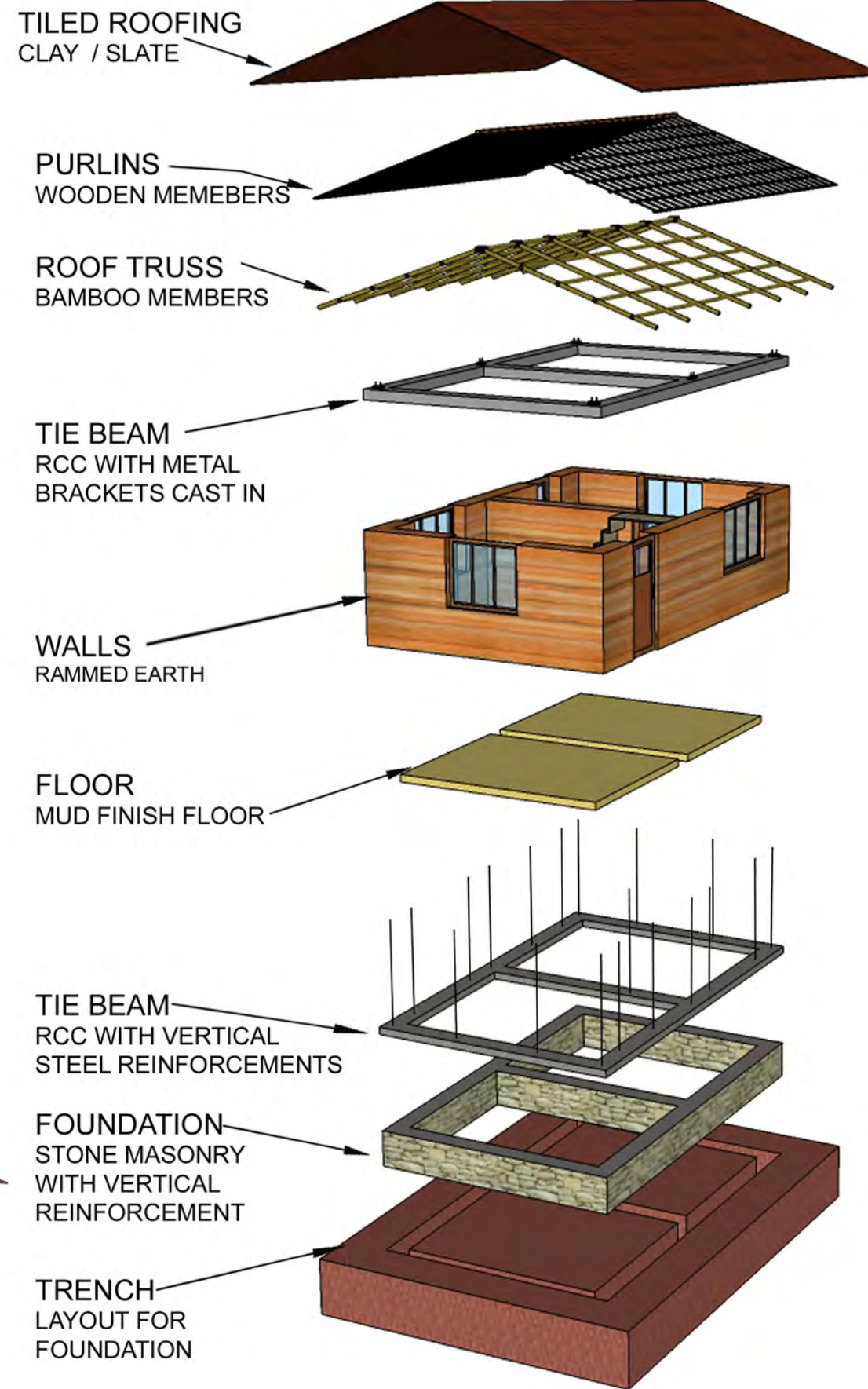

WALL SECTION



VIEW

SPECIFICATIONS

| | |
|-------------------|-------------------------------|
| FLOOR AREA | 310 SQFT |
| MATERIALS | |
| FOUNDATION | STONE MASONRY + RCC BEAM |
| WALLS | RAMMED EARTH |
| BEAMS | RCC TIE BEAM |
| FLOORS | MUD FLOOR(G) WOOD (FF) |
| REINFORCEMENTS | STEEL BARS |
| ROOF | BAMBOO WITH WOOD PURLINS |
| COST | ESTIMATED 3,50,000 NRS |

RAMMED EARTH TWO STOREY BUILDING



FLOOR PLANS

TILED ROOFING
CLAY / SLATE

PURLINS
WOODEN MEMEBERS

ROOF TRUSS
BAMBOO MEMBERS

TIE BEAM
RCC WITH METAL
BRACKETS CAST IN

WALLS
RAMMED EARTH

UPPER FLOOR
WOODEN FLOOR
& BAMBOO BEAMS

VERTICAL
REINFORCEMENT
STEEL RODS SET IN BEAM

TIE BEAM
RCC WITH METAL
BRACKETS CAST IN

FLOOR
MUD FINISH FLOOR

TIE BEAM
RCC WITH VERTICAL
STEEL REINFORCEMENTS

FOUNDATION
STONE MASONRY
WITH VERTICAL
REINFORCEMENT

TRENCH
LAYOUT FOR
FOUNDATION

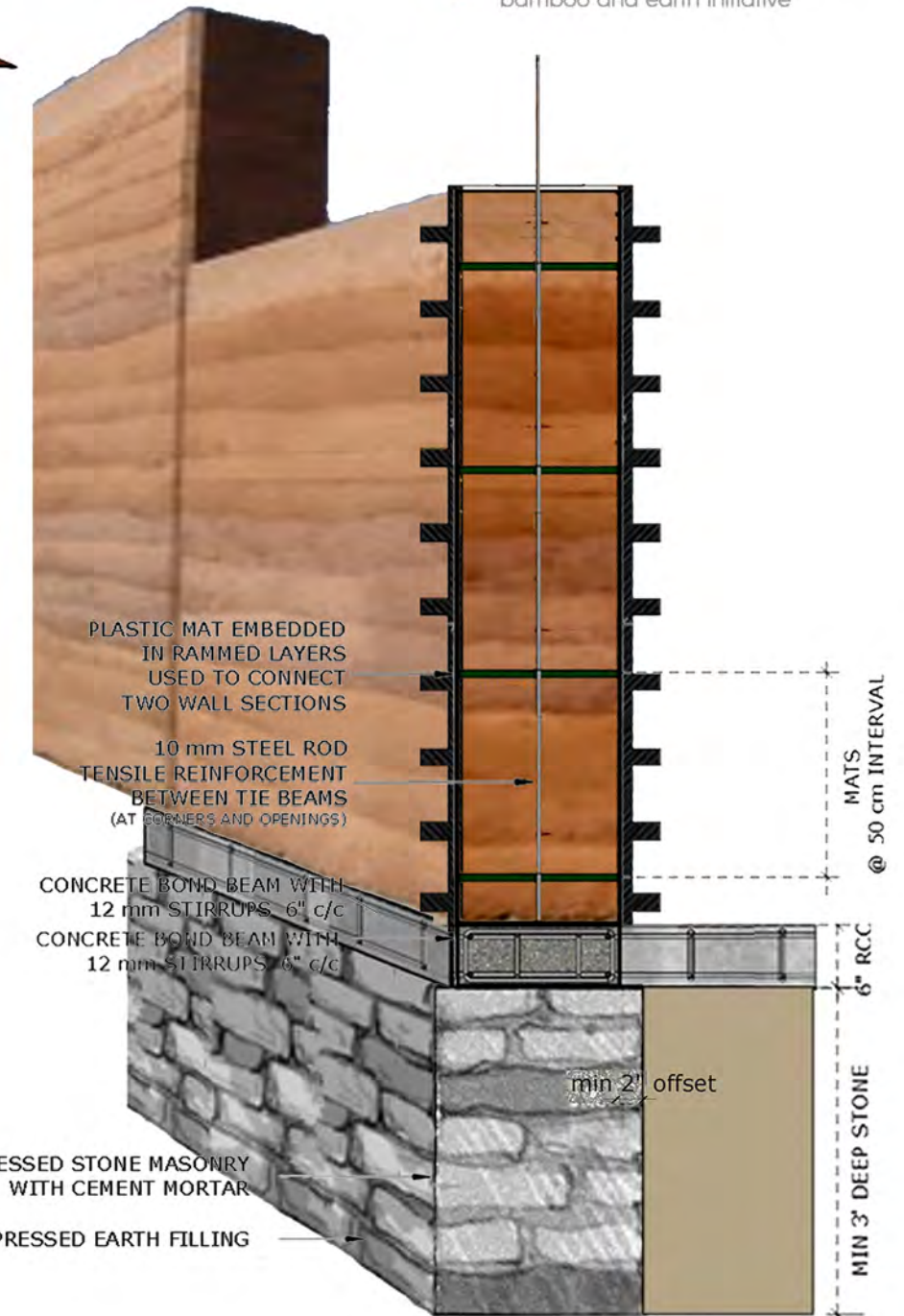
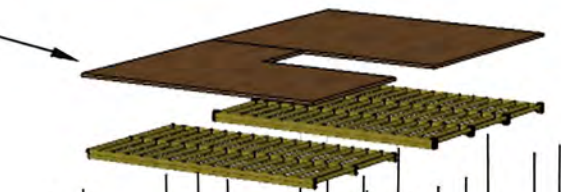

WALL SECTION



VIEW

SPECIFICATIONS

| | |
|-------------------|-------------------------------|
| FLOOR AREA | 610 SQFT |
| MATERIALS | |
| FOUNDATION | STONE MASONRY + RCC BEAM |
| WALLS | RAMMED EARTH |
| BEAMS | RCC TIE BEAM |
| FLOORS | MUD FLOOR(G) WOOD (FF) |
| REINFORCEMENTS | STEEL BARS |
| ROOF | BAMBOO WITH WOOD PURLINS |
| COST | ESTIMATED 6,50,000 NRS |